

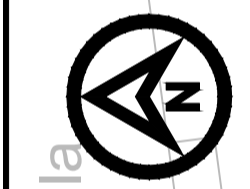

SEE DWG PB8155-RHD-GE-SW-DR-Z-0103 VIEWPORT 5

VIEWPORT 13



SEE VIEWPORT 13

VIEWPORT 14

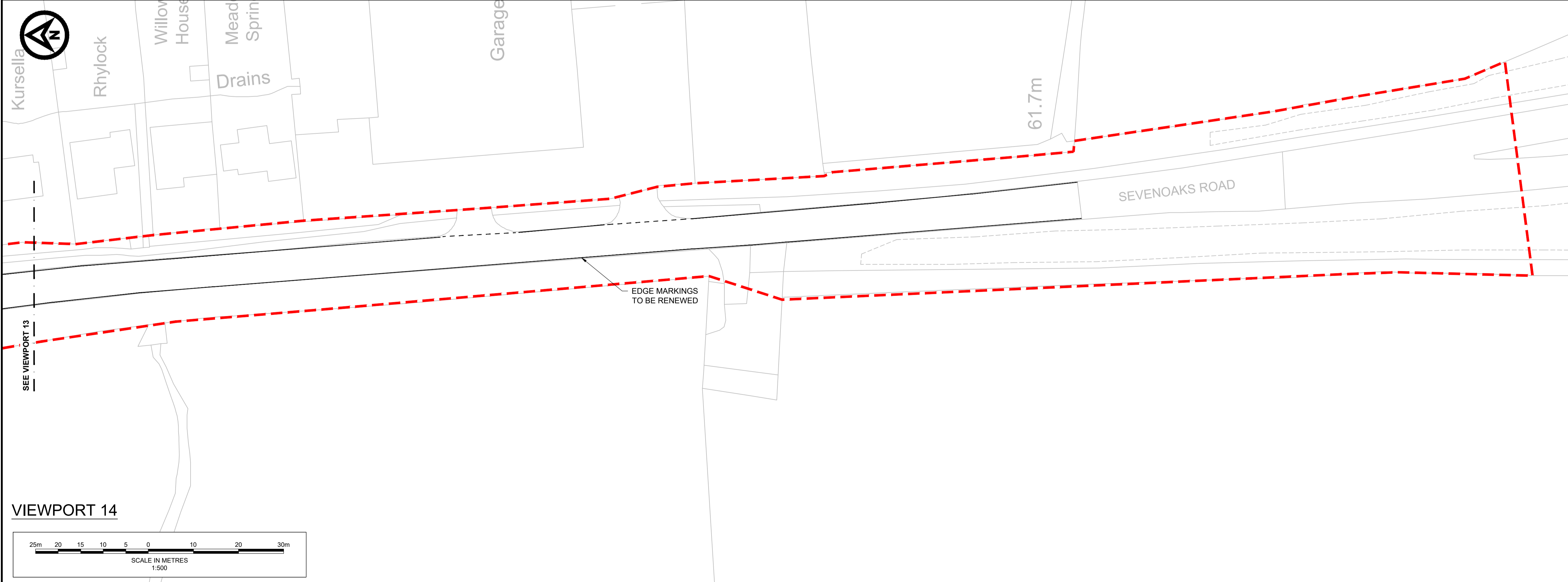
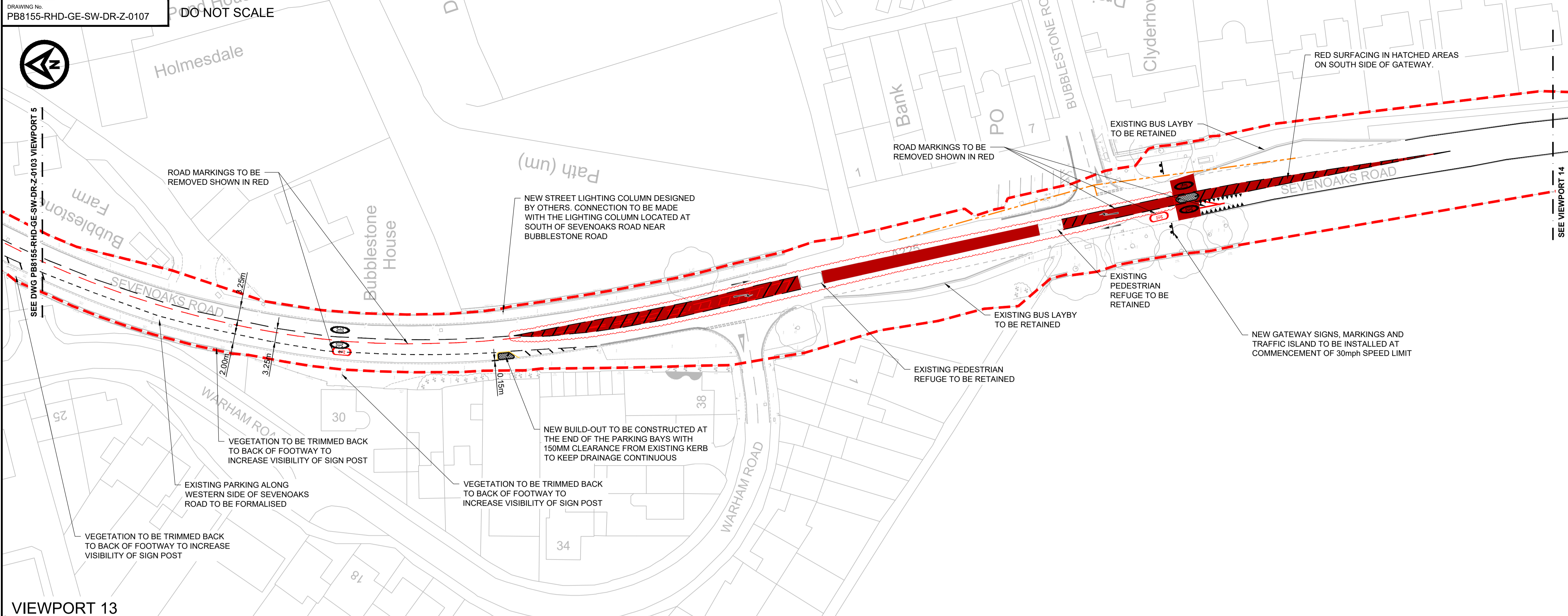
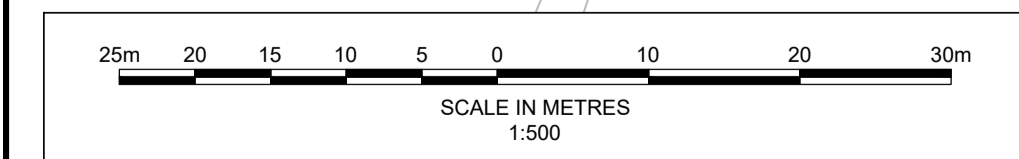

- NOTES
1. Do not scale from this drawing. All dimensions are in metres unless noted otherwise.
 2. All levels are in metres relative to Ordnance Datum Newlyn unless noted otherwise.
 3. This drawing has been based upon Ordnance survey and Topographical survey information supplied by Greenhatch, and Royal HaskoningDHV cannot guarantee the accuracy of data.

- KEY
- - - S278 WORKS BOUNDARY
 - Traffic Signs
 - GLASDON GATEWAY SIGN
 - TMP METRO PLUS ANTI-TWIST NON-ILLUMINATED REFLEX BOLLARD
 - BELISHA BEACON
 - BUFF TACTILE PAVING
 - RED TACTILE PAVING
 - RED HIGH FRICTION SURFACING
 - LOW LEVEL PLANTING AREA (3m CLEAR GAP BETWEEN PLANTING AND EXISTING HEDGE LINE)
 - PROPOSED ROAD MARKINGS
 - EXISTING ROAD MARKINGS
 - RAISED TABLE RAMP
 - NEW FOOTWAY TO BE CONSTRUCTED
 - BRINDLE COLOUR BLOCK PAVING
 - VERGE TO BE RE-GRADED AND SEEDED
 - 2.4m x 45m VISIBILITY SPLAY

SEVENOAKS ROAD

- 1) Parking along western side of carriageway on approach to pond to be formalised with parking bays and a 'bookend' build-out (pavement extension) at southern end.
- 2) Overhanging vegetation on approach to pond on western boundary to be cut back.
- 3) New traffic island south side of Bubblestone Road to reduce carriageway width.
- 4) 30mph limit Gateway feature with central red road surfacing and speed limit road markings.
- 5) Central hatching with red road surfacing from Bubblestone Road approach through to north side of Warham Road and at pond junction.
- 6) Carriageway white edge line markings to visually narrow road width.